

FORM NO. 1.

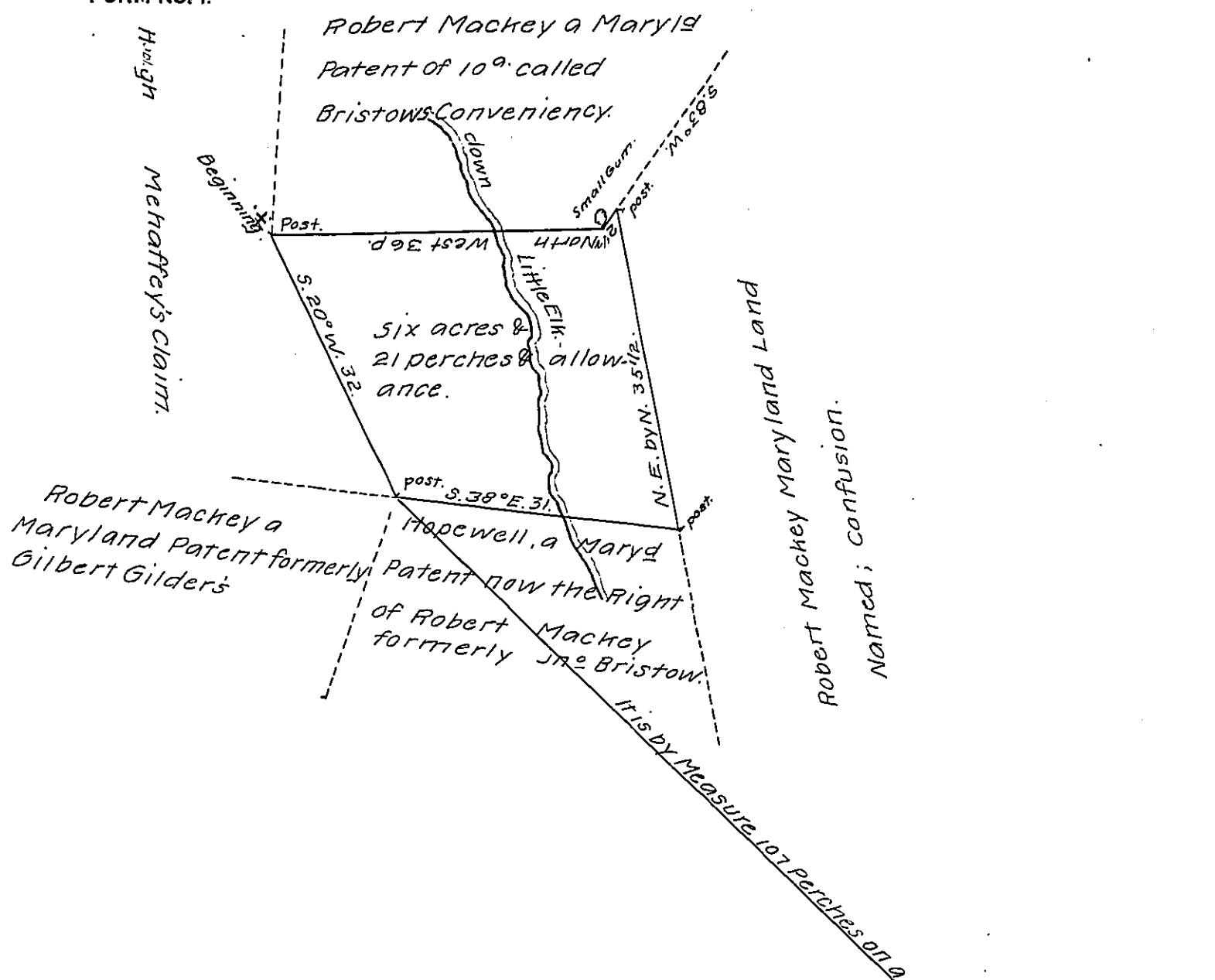

The Annexed Draught describes a Vacancy of 6² 21 p^s & allowance which lays between three Maryland Patents now the Right of Robert Mackey, & begins at the Beginning Corner of his 10⁹ Patent called Bristow's Conveniency marked thus †. I was desired th/_{th} this Return to Annex the Draughts of the Land Contiguous thereto w^{ch} is a Thing attended with difficulty especially on Account of Hugh Mehaffey whose Land I believe was never survey'd by a Pennsylvania Right because claimed by another Person Under Maryland Right, nor would Hugh be willing to let me go round it so as to be capable to make a Draught; I have therefore omitted ^{it}/_{it} Draughts of the other Land I thought Needless as I have Particularly described how each Joins this Vacancy George Churchman. —

Situate on Little Elk in East Nottingⁿ Township. A Scale of 20^{P^s} to an Inch.

IN TESTIMONY that the above is a copy of the original remaining on file in the Department of Internal Affairs of Pennsylvania, made conformably to an Act of Assembly approved the 16th day of February 1833, I have hereunto set my hand and caused the Seal of said Department to be affixed at Harrisburg, this twenty third day of December, 1907.

Henry Horner
Secretary of Internal Affairs.